

METRO TOOLS

**L-3, KEVAL SHOPING CENTRE,
OPP. RAJKAMAL ARCADE,
OLD N.H NO:8 , G.I.D.C.
ANKLESHWAR-393001.**

**MOBILE NO: +91 9224121200 ,
+91 7802042901.**

EMAIL-ID: metrotoolsindia@gmail.com

INSULA®
Insulated Tools for Electrical Safety

GETS FE

INDUSTRIAL SAFETY EQUIPMENT

OUR TOOLS ARE TESTED UNDER



IMPACT TEST

There are two tests carried out: The first test is performed at an ambient of $-25 \pm 3^{\circ}\text{C}$ (the tools lay in a cold chamber for 2 hours), if with C marked test need to be done by $-40 \pm 3^{\circ}\text{C}$ and is carried out 120 seconds after the tools have been removed from the chamber. The second test is carried out at ambient temperature of $23 \pm 5^{\circ}\text{C}$. The hammer is allowed to fall freely on three different places of the insulated material. The test piece is acceptable if the handle is not cracked, broken or does not show signs of faking. This test can be compared to a fall of the tool from a height of 0.6m at a temperature of -25°C and a fall from a height of 2m at room temperature.



ELECTRICAL TEST

Before testing, the tools are immersed in a bath of water at room temperature of 24 hours (± 0.5 hours). The test pieces are acceptable if there is no electrical discharge, spark over or flashover, during the 3 minutes of testing at a voltage of 10 KV.



STAMP TEST

The indenter, loaded with a weight of 20N and a voltage of 5 KV, is applied to the centre of the handle. The test is successful if the test piece subsequently passes the electrical test.

INSULATION TEST

Before testing the test piece is heated to $70^{\circ}\text{C} \pm 3^{\circ}\text{C}$ for 168 hours. The hanger is loaded with weights (500N), wrenches and sockets sets with weights (100N). The duration of test is 3 minutes after the test piece has been removed from heat. The test piece is acceptable if the handle remains firmly attached to the conducting part after 3 minutes of testing.



FLAME RETARDANCY TEST

The flame is applied to the test piece for 10 seconds. The test piece is acceptable if the height of the flame on the burning handle does not exceed 120mm in an observation period of 20 seconds after the burner has been removed.

CERTIFICATIONS



VDE

The VDE Testing and Certification Institute is a nationally and internationally accredited institution in the field of testing and certification of electrical engineering devices, components and systems. These electrical products are tested for safety, electromagnetic compatibility and other product properties.



VDE - GS MARK

Technical working equipment and consumable materials subject to the applicable device and product safety laws bear the VDE-GS mark, which stands for the safety of the product with regard to electrical, mechanical, thermal, toxicological, radiological and other dangers. In addition, tools with the VDE-GS mark conform to the VDE regulations or European or internationally harmonised standards, i.e. they confirm the compliance with the safety requirements of the respective guidelines.



DOUBLE TRIANGLE AND VOLTAGE RANGE

If insulated tools or aids are marked with the symbol of the double triangle and the assigned voltage or voltage range specification or the class, they are suitable for working on energised parts at the stated voltage.



IEC 60900

An international standard which, among other things, describes the design of insulated tools in detail. For example, the thickness of the protective insulation is specified. In addition, the standard defines individual tests (piece tests) as well as series and random sample tests for checking the electrical safety of the protective insulation.

INSULA

INSULATED HAND TOOLS FOR ELECTRICAL SAFETY

1000 Volts insulated tools

Electrical Cars, Automation, IoT, & AI in the Industrial space are already here. To support new as well as existing technologies requires the industry to maintain labyrinth network of electrical cables, circuitries & panels. In our quest to be more intelligent 'safety' cannot be neglected at any point. For regular operations & maintenance of electrical equipment & circuitry requires the correct set of tools. Our full range of Insulated Hand Tools have been providing to the industry the tools needed for the above.

Why 1000 Volts insulated tools?

The working end (business end) of hand tools are made from regular steel or chrome vanadium. This poses a major risk of shock for operators performing electrical operation or maintenance. Insulated tools are basically made from regular steel alloy with a PVC insulation that is applied using either of the 2 processes – dipping or injection moulding. Both these processes are carefully applied to each tool to ensure correct amount of insulation.

WHY CHOOSE INSULA



When working in live wires/ systems these tools provide insulation from electric shock



During electrical ops & maint systems remain energized even after shutdown. These tools provide safety to operator from fatal shock

SPECIALLY FOR INDUSTRIES



Control Panels



Live Wires



Batteries



Electrical Cars



Busbars

BRANDS THAT TRUST INSULA



Reliance



HBL



Gracim Industries



Hindalco



Birla Copper



JSW Steel



ABB India



Siemens



IOCL



GAIL



Hatsun Agra Product Ltd



NTPC



Mondelēz India Foods Pvt Ltd



Mylan laboratories



Honda R&D (India) Pvt Ltd



Zydus Hospira Oncology Ltd



Shapoorji pallonji Bumi Armada



United Breweries

SCREWDRIVER

INSULATED SLOTTED SCREWDRIVER (-)

| | | A | B | CxD | L | PN |
|-----|-----|-----|-----|--------|-----|--------|
| 0.4 | 2.5 | 2.5 | 75 | 95x25 | 170 | IC0204 |
| 0.5 | 3.0 | 3.0 | 100 | 95x25 | 195 | IC0205 |
| 0.6 | 3.5 | 3.5 | 100 | 95x25 | 195 | IC0206 |
| 0.8 | 4.0 | 4.0 | 100 | 105x30 | 205 | IC0208 |
| 1.0 | 5.5 | 5.5 | 125 | 115x35 | 240 | IC0210 |
| 1.2 | 6.5 | 6.5 | 150 | 115x35 | 265 | IC0212 |

INSULATED SLIM TYPE SLOTTED SCREWDRIVER (-)

| | | A | B | CxD | L | PN |
|-----|-----|-----|-----|--------|-----|--------|
| 0.5 | 3.0 | 3.0 | 100 | 95x25 | 195 | IC0305 |
| 0.6 | 3.5 | 3.5 | 100 | 95x25 | 195 | IC0306 |
| 0.8 | 4.0 | 4.0 | 100 | 105x30 | 205 | IC0308 |
| 1.0 | 5.5 | 5.5 | 125 | 115x35 | 240 | IC0310 |
| 1.2 | 6.5 | 6.5 | 150 | 115x35 | 265 | IC0312 |

INSULATED PHILLIPS SCREWDRIVER

| | A | B | CxD | L | PN |
|-----|-----|-----|--------|-----|--------|
| PH0 | 3.0 | 60 | 95x25 | 155 | IC0400 |
| PH1 | 5.0 | 80 | 105x30 | 185 | IC0401 |
| PH2 | 6.0 | 100 | 115x35 | 215 | IC0402 |
| PH3 | 8.0 | 150 | 118x41 | 268 | IC0403 |

INSULATED SLIM TYPE PHILLIPS SCREWDRIVER

| | A | B | CxD | L | PN |
|-----|-----|-----|--------|-----|--------|
| PH1 | 5.0 | 80 | 105x30 | 185 | IC0501 |
| PH2 | 6.0 | 100 | 115x35 | 215 | IC0502 |
| PH3 | 8.0 | 150 | 118x41 | 268 | IC0503 |

INSULATED POZI SCREWDRIVER



| | A | B | CxD | L | PN |
|-----|-----|-----|--------|-----|--------|
| PZ0 | 3.0 | 60 | 95x25 | 155 | IC0600 |
| PZ1 | 5.0 | 80 | 105x30 | 185 | IC0601 |
| PZ2 | 6.0 | 100 | 115x35 | 215 | IC0602 |
| PZ3 | 8.0 | 150 | 118x41 | 268 | IC0603 |

INSULATED TX SCREWDRIVER



| | A | B | CxD | L | PN |
|-----|-----|-----|--------|-----|--------|
| T10 | 3.0 | 70 | 95x25 | 165 | IC0810 |
| T15 | 4.0 | 80 | 105x30 | 185 | IC0815 |
| T20 | 4.0 | 100 | 105x30 | 205 | IC0820 |
| T25 | 5.0 | 125 | 115x35 | 230 | IC0825 |
| T30 | 6.0 | 130 | 115x35 | 245 | IC0830 |

INSULATED NUT SCREWDRIVER



| | A | B | E | CxD | L | PN |
|------|-----|-----|----|--------|-----|--------|
| 6.0 | 7.2 | 125 | 31 | 105x30 | 230 | IC1206 |
| 7.0 | 7.2 | 125 | 31 | 105x30 | 230 | IC1207 |
| 8.0 | 7.2 | 125 | 31 | 105x30 | 230 | IC1208 |
| 9.0 | 7.2 | 125 | 31 | 105x30 | 230 | IC1209 |
| 10.0 | 7.2 | 125 | 31 | 105x30 | 230 | IC1210 |
| 11.0 | 8.1 | 125 | 31 | 118x41 | 243 | IC1211 |
| 12.0 | 8.1 | 125 | 31 | 118x41 | 243 | IC1212 |
| 13.0 | 8.1 | 125 | 31 | 118x41 | 243 | IC1213 |
| 14.0 | 8.1 | 125 | 31 | 118x41 | 243 | IC1214 |

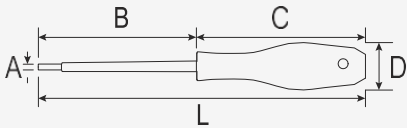

12PC INSULATED CHANGEABLE SCREWDRIVER SET



| Content | | | PN |
|---------|------------------------|-------------|---------|
| ⊖ | 0.4x2.0x100 | 0.4x2.5x100 | IC3212 |
| | 0.5x3.0x100 | 0.6x3.5x100 | |
| | 1.0x5.5x100 | 1.2x6.5x100 | |
| ⊕ | PH0x100 | PH1x100 | PH2x100 |
| | Voltage Tester: 3.0x70 | | |
| | Handle: 31x105 | | |



50PC INSULATED CHANGEABLE SCREWDRIVER SET





| Content | | | | | | PN | |
|---|------------------------|-------------|-------------|-------------|--------|-------------|---------|
|  | 0.4x2.0x100 | 0.4x2.5x100 | 0.5x3.0x100 | | IC3450 | | |
| | 0.6x3.5x100 | 0.8x4.0x100 | 1.0x5.5x100 | 1.2x6.5x100 | | | |
|  | PH0x100 | PH1x100 | PH2x100 | | | | |
|  | PZ0x100 | PZ1x100 | PZ2x100 | | | | |
|  | T6x100 | T8x100 | T9x100 | T10x100 | | T15x100 | T20x100 |
| | T25x100 | T27x100 | T30x100 | | | | |
|  | H2.5x100 | H3.0x100 | H4.0x100 | H5.0x100 | | H6.0x100 | |
|  | R1x100 | R2x100 | | | | | |
|  | TRI 1x100 | TRI 2x100 | | TRI 3x100 | | TRI 4x100 | |
|  | TORO 4x100 | TORO 6x100 | | TORO 8x100 | | TORO 10x100 | |
| | M4x4.0x100 | M5x5.0x100 | | M6x5.0x100 | | | |
|  | 4x100 | 6x100 | | 8x100 | 10x100 | | |
| | M4x4.0x100 | M5x5.0x100 | | M6x5.0x100 | | | |
|  | 6.3x89 | 8.1x89 | | | | | |
|  | 89 | | | | | | |
| | 89 | | | | | | |
|  | 89 | | | | | | |
| | Voltage Tester: 3.0x70 | | | | | | |
| Handle: 31x105 | | | | | | | |





 1000V

PLIER

INSULATED COMBINATION PLIER



| mm |  |  | PN |
|-----|---|---|--------|
| 160 | 2.0 | 1.6 | DA0116 |
| 200 | 2.5 | 2.2 | DA0120 |



 1000V



INSULATED SNIPE NOSE SIDE CUTTING PLIER



| mm | | | PN |
|-----|-----|-----|--------|
| 160 | 2.0 | 1.6 | DA0316 |
| 200 | 2.4 | 2.0 | DA0320 |







INSULATED CURVED NOSE CUTTING PLIER



| mm |  |  | PN |
|-----|---|---|--------|
| 160 | 2.0 | 1.6 | DA0516 |
| 200 | 2.4 | 2.0 | DA0520 |







INSULATED DIAGONAL CUTTING PLIER



| mm |  |  | PN |
|-----|---|---|--------|
| 160 | 2.0 | 1.6 | DA0716 |



 1000V

INSULATED HEAVY DUTY DIAGONAL CUTTING PLIER

| mm |  |  | PN |
|-----|---|---|--------|
| 180 | 2.0 | 1.6 | DA0718 |



 1000V

INSULATED WIRE STRIPPER

| mm | mm |  mm ² | PN |
|-----|-----|---|--------|
| 160 | 5.0 | 10.0 | DA1316 |



INSULATED WATER PUMP PLIER

| mm | mm (Max) | PN |
|-----|----------|--------|
| 300 | 35 | DA1530 |



INSULATED CABLE SHEAR

| mm |  mm | mm ² | PN |
|-----|---|-----------------|--------|
| 250 | 250 | 80 | DA1825 |

INSULATED RATCHETING CABLE CUTTER

| | mm (Max) | mm ² (Max) | PN |
|----|----------|-----------------------|--------|
| 32 | | 240 | IA2024 |
| 52 | | 380 | IA2038 |



INSULATED PLASTIC CLAMP

| mm | PN |
|-----|--------|
| 200 | IF1020 |



WRENCH

INSULATED OPEN WRENCH



| S | A | B | L | PN |
|----|------|------|-----|--------|
| 6 | 7.0 | 22 | 90 | DD0106 |
| 7 | 7.0 | 24 | 90 | DD0107 |
| 8 | 7.5 | 25.5 | 100 | DD0108 |
| 9 | 7.5 | 27.5 | 100 | DD0109 |
| 10 | 8.0 | 29 | 110 | DD0110 |
| 11 | 8.5 | 31 | 110 | DD0111 |
| 12 | 8.5 | 33 | 130 | DD0112 |
| 13 | 10.5 | 34 | 135 | DD0113 |

| | | | | |
|----|------|------|-----|--------|
| 18 | 12.0 | 44.5 | 175 | DD0118 |
| 19 | 12.5 | 48 | 175 | DD0119 |
| 21 | 12.5 | 51 | 195 | DD0121 |
| 22 | 13.0 | 54 | 195 | DD0122 |
| 24 | 13.5 | 56 | 225 | DD0124 |
| 27 | 14.8 | 61 | 250 | DD0127 |
| 30 | 14.8 | 66 | 290 | DD0130 |
| 32 | 15.8 | 70 | 310 | DD0132 |

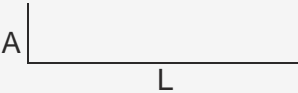

20 PCS INSULATED OPEN WRENCH TOOL KIT

6mm, 7mm, 8mm, 9mm, 10mm, 11mm,
12mm, 13mm, 14mm, 15mm, 16mm,
17mm, 18mm 19mm, 21mm, 24mm,
27mm, 30mm, 32mm



INSULATED RING WRENCH



| S | A | B | L | PN |
|----|------|------|-----|--------|
| 6 | 7.0 | 22 | 90 | DD0306 |
| 7 | 7.0 | 24 | 90 | DD0307 |
| 8 | 7.5 | 25.5 | 100 | DD0308 |
| 9 | 7.5 | 27.5 | 100 | DD0309 |
| 10 | 8.0 | 29 | 110 | DD0310 |
| 11 | 8.5 | 31 | 110 | DD0311 |
| 12 | 8.5 | 33 | 130 | DD0312 |
| 13 | 10.5 | 34 | 135 | DD0313 |
| 14 | 10.5 | 37 | 145 | DD0314 |
| 15 | 11.5 | 40 | 150 | DD0315 |
| 16 | 11.5 | 42 | 160 | DD0316 |
| 17 | 12.0 | 44 | 160 | DD0317 |
| 18 | 12.0 | 44.5 | 175 | DD0318 |
| 19 | 12.5 | 48 | 175 | DD0319 |
| 21 | 12.5 | 51 | 195 | DD0321 |
| 22 | 13.0 | 54 | 195 | DD0322 |
| 24 | 13.5 | 56 | 225 | DD0324 |
| 27 | 14.8 | 61 | 250 | DD0327 |
| 30 | 14.8 | 66 | 290 | DD0330 |
| 32 | 15.8 | 70 | 310 | DD0332 |

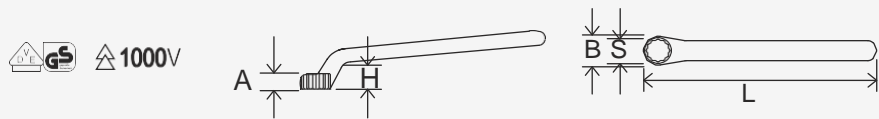

20 PCS INSULATED RING WRENCH TOOL SET

6mm, 7mm, 8mm, 9mm, 10mm, 11mm, 12mm, 13mm, 14mm, 15mm, 16mm, 17mm, 18mm 19mm, 21mm, 24mm, 27mm, 30mm, 32mm



INSULATED ADJUSTABLE WRENCH



| mm | S (Max)mm | PN |
|-----|-----------|--------|
| 200 | 24 | DD0520 |
| 250 | 28 | DD0525 |
| 300 | 32 | DD0530 |



INSULATED ALLEN KEY



| mm | ⬡ (mm) | PN |
|-----|--------|--------|
| 130 | 3 | DD2503 |
| 140 | 4 | DD2504 |
| 160 | 5 | DD2505 |
| 180 | 6 | DD2506 |
| 200 | 8 | DD2508 |
| 235 | 10 | DD2510 |
| 260 | 12 | DD2512 |



INSULATED HEX KEY T-TYPE WITH BALL END



| ⬡ | D | L | H | PN |
|---|----|-----|----|--------|
| 3 | 15 | 150 | 95 | ID0703 |
| 4 | 15 | 150 | 95 | ID0704 |
| 5 | 15 | 150 | 95 | ID0705 |
| 6 | 15 | 150 | 95 | ID0706 |
| 8 | 15 | 150 | 95 | ID0708 |

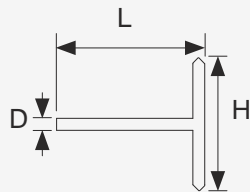

SOCKETS & ACCESSORIES

INSULATED SOCKET

| | mm | D | H | PN |
|------|----|------|----|--------|
| 3/8" | 08 | 10 | 54 | DD1508 |
| | 10 | 18.7 | 54 | DD1510 |
| | 11 | 20.0 | 54 | DD1511 |
| | 12 | 21.2 | 54 | DD1512 |
| | 13 | 22.3 | 54 | DD1513 |
| | 14 | 23.7 | 54 | DD1514 |
| | 16 | 26.4 | 54 | DD1516 |
| | 17 | 26.7 | 54 | DD1517 |
| | 18 | 28.7 | 54 | DD1518 |
| | 19 | 29.0 | 54 | DD1519 |
| | 21 | 31.0 | 54 | DD1521 |
| | 22 | 33.0 | 54 | DD1522 |
| 1/2" | 10 | 18.7 | 54 | DD1310 |
| | 11 | 20.0 | 54 | DD1311 |
| | 12 | 21.2 | 54 | DD1312 |
| | 13 | 22.3 | 54 | DD1313 |
| | 14 | 23.7 | 54 | DD1314 |
| | 16 | 26.4 | 54 | DD1316 |
| | 17 | 26.7 | 54 | DD1317 |
| | 18 | 28.7 | 54 | DD1318 |
| | 19 | 29.0 | 54 | DD1319 |
| | 21 | 31.0 | 54 | DD1321 |
| | 22 | 33.0 | 54 | DD1322 |
| | 24 | 35.3 | 54 | DD1324 |
| | 27 | 40.0 | 54 | DD1327 |
| | 30 | 43.1 | 54 | DD1330 |
| | 32 | 45.1 | 54 | DD1332 |

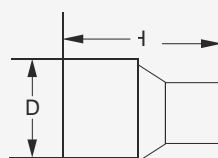

1000V

INSULATED ALLEN SOCKET

| | mm | D | PN |
|------|-----|----|--------|
| 3/8" | 120 | 4 | DD1904 |
| | 120 | 5 | DD1905 |
| | 120 | 6 | DD1906 |
| | 120 | 8 | DD1908 |
| 1/2" | 120 | 4 | DD1704 |
| | 120 | 5 | DD1705 |
| | 120 | 6 | DD1706 |
| | 120 | 8 | DD1708 |
| | 120 | 10 | DD1710 |

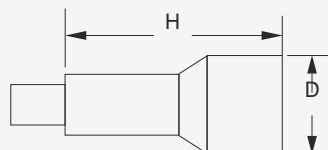

1000V

INSULATED RATCHET WRENCH

| | mm | PN |
|------|-----|--------|
| 3/8" | 200 | DD2138 |
| 1/2" | 250 | DD2112 |

1000V



INSULATED EXTENSION BAR

| | mm | PN |
|------|-----|--------|
| 3/8" | 125 | DD2303 |
| | 250 | DD2304 |
| 1/2" | 125 | DD2301 |
| | 250 | DD2302 |

1000V



INSULATED L- HANDLE

| | mm | PN |
|------|-----|--------|
| 1/2" | 270 | DD2812 |

1000V



INSULATED T- HANDLE

| | mm | H | PN |
|------|-----|-----|--------|
| 3/8" | 200 | 155 | DD1138 |
| 1/2" | 200 | 155 | DD1112 |

1000V



INSULATED SOCKET WRENCH

| | D | L | H | PN |
|----|------|-----|-----|--------|
| 8 | 15.0 | 200 | 145 | DD0908 |
| 10 | 19.5 | 300 | 145 | DD0920 |
| 12 | 22.0 | 300 | 145 | DD0922 |
| 13 | 23.5 | 300 | 145 | DD0923 |
| 14 | 24.5 | 300 | 145 | DD0924 |
| 16 | 27.0 | 300 | 145 | DD0926 |
| 17 | 28.5 | 300 | 145 | DD0927 |
| 18 | 29.5 | 300 | 145 | DD0928 |
| 19 | 31.0 | 300 | 145 | DD0929 |

1000V

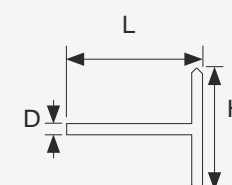

INSULATED TORQUE WRENCH

| | N.m | PN |
|------|--------|--------|
| 3/8" | 5-25 | ID2008 |
| | 10-50 | ID2012 |
| | 20-100 | ID2016 |
| 1/2" | 10-50 | ID3012 |
| | 20-100 | ID3016 |
| | 40-200 | ID3020 |

1000V



KNIFE

INSULATED CABLE KNIFE (STRAIGHT)

| mm | D | PN |
|-----|----|--------|
| 180 | 50 | IE0418 |



INSULATED DISMANTLING KNIFE (SEMICIRCLE)

| mm | D | PN |
|-----|----|--------|
| 155 | 28 | IE0616 |



INSULATED DISMANTLING KNIFE (LONG HOOK)

| mm | D | PN |
|-----|----|--------|
| 180 | 50 | IE1018 |



INSULATED CABLE KNIFE (GUARD)

| mm | D | PN |
|-----|----|--------|
| 180 | 50 | IE1218 |



INSULATED DISMANTLING KNIFE

| mm | D | PN |
|-----|----|--------|
| 155 | 38 | IE1416 |

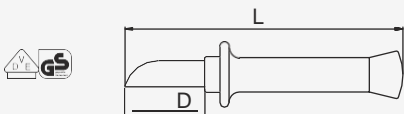

ACCESSORIES

INSULATED HACKSAW FRAME

| D | L | PN |
|-----|-----|--------|
| 150 | 300 | IE0230 |

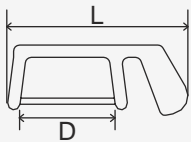

INSULATED Mallet

| mm | Φ mm | Wt/ kg | PN |
|-----|------|--------|--------|
| 315 | 30 | 0.6 | IG1030 |



INSULATED TWEEZER

| mm | PN |
|-----|--------|
| 130 | IF0213 |

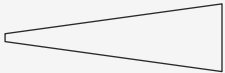

INSULATED GLOVES



TOOL SETS

25PC INSULATED TOOLKIT



| Content | mm | PN |
|-------------------------------------|--|--------|
| Insulated Combination Plier | 200 | IH0825 |
| Insulated Diagonal Plier | 160 | |
| 6Pcs Insulated Screwdriver | PH: PH0x60, PH1x80, PH2x100 SL: 0.6X3.5X100, 0.8X4.0X100, 1.0X5.5X125 | |
| Insulated Cable Knife(Straight) | 50x180 | |
| Insulated Cable Knife(Semicircle) | 28x155 | |
| 7Pcs 1/2" Insulated Sockets | 10, 11, 12, 13, 14, 17, 19 | IH0825 |
| 7Pcs 1/2" Insulated Open End Wrench | 10, 11, 12, 13, 14, 17, 19 | |
| 1/2" Insulated T-Handle | -- | |



31PC INSULATED TOOLKIT

| Content | mm | PN |
|-------------------------------------|--|--------|
| Insulated Combination Plier | 200 | IH0831 |
| Insulated Diagonal Plier | 160 | |
| 6Pcs Insulated Screwdriver | PH: PH0x60, PH1x80, PH2x100 SL: 0.6X3.5X100, 0.8X4.0X100, 1.0X5.5X125 | |
| Insulated Cable Knife(Straight) | 50x180 | |
| Insulated Cable Knife(Semicircle) | 28x155 | |
| 7Pcs 1/2" Insulated Sockets | 10, 11, 12, 13, 14, 17, 19 | IH0831 |
| 7Pcs 1/2" Insulated Open End Wrench | 10, 11, 12, 13, 14, 17, 19 | |
| 1/2" Insulated T-Handle | -- | |
| Insulated Allen Key | 3, 4 , 5, 6, 8, 10 | |



52PC INSULATED TOOL SET

| Content | PN |
|---------|--------|
| A Tray | IH1852 |
| B Tray | |
| C Tray | |
| D Tray | |



1000V

INSULATED A TRAY

| Content | PN |
|-----------------------|--------|
| 6 pcs Pliers | IH1946 |
| 7" Combination Pliers | |
| 8" Long Nose Pliers | |
| 6" Diagonal Cutter | |
| 6" Stripping Pliers | |
| 10" Water Pump Pliers | |
| 6" Cable Cutter | |

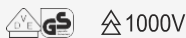

1000V

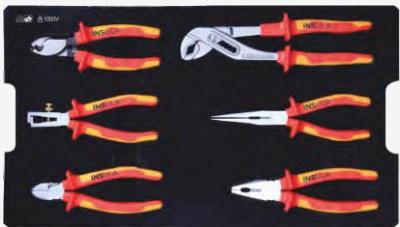

INSULATED B TRAY

| Content | PN |
|---|--------|
| 11 pcs Screwdrivers, Knife & Tester | IH1947 |
| PH0X60, PH1X80, PH2X100, PH3X150 | |
| 2.5x75mm, 3x100mm, 4x100mm, 5.5x125mm,6.5x150mm | |
| Straight Knife | |
| Voltage Tester | |



1000V



INSULATED C TRAY

| Content | PN |
|---|--------|
| 21 pcs 1/2" Sockets and Accessory | IH1948 |
| Sockets Bits: 4, 5, 6, 8mm | |
| Sockets: 10/ 11/ 12/ 13/ 14/ 16/ 17/ 18/ 19/ 21/ 22/ 24/ 27 | |
| Extension Bar 5" & 10" | |
| T Handle | |
| Ratchet Handle | |

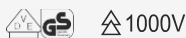

1000V



INSULATED D TRAY

| Content | PN |
|---|--------|
| 14 pcs Open Wrenches and Adjustable Wrenches | IH1949 |
| Open Wrench: 8/ 9/ 10/ 11/ 12/ 13/ 14/ 15/ 16/ 17/ 18/ 19/ 22/ 24 | |
| 8" Adjustable Wrench | |



1000V



OUR PRODUCT VERTICALS

GETS FE

INDUSTRIAL SAFETY EQUIPMENT

MEASURE UP

MEASURING EQUIPMENT FOR INDUSTRIAL NEEDS

TOOL IT

TOOLS FOR ASSEMBLY, OPERATION & MAINTENANCE

METRO TOOLS

**L-3, KEVAL SHOPING CENTRE,
OPP. RAJKAMAL ARCADE,
OLD N.H NO:8 , G.I.D.C.
ANKLESHWAR-393001.**

**MOBILE NO: +91 9224121200 ,
+91 7802042901.**

EMAIL-ID: metrotoolsindia@gmail.com